



## VESTIL MANUFACTURING CORP.

2999 North Wayne Street, P.O. Box 507, Angola, IN 46703

Telephone: (260) 665-7586 -or- Toll Free (800) 348-0868

Fax: (260) 665-1339

www.vestilmfg.com e-mail: [sales@vestil.com](mailto:sales@vestil.com)

# TRI-SERIES TRIPODS INSTRUCTION MANUAL



### **Receiving instructions:**

After delivery, IMMEDIATELY remove the packaging from the product in a manner that preserves the packaging and maintains the orientation of the product in the packaging; then inspect the product closely to determine whether it sustained damage during transport. **If damage is discovered during the inspection, immediately record a complete description of the damage on the bill of lading.** If the product is undamaged, discard the packaging.

### **NOTES:**

- 1) Compliance with laws, regulations, codes, and non-voluntary standards enforced in the location where the product is used is exclusively the responsibility of the owner/end-user.
- 2) VESTIL is **not liable** for any injury or property damage that occurs as a consequence of failing to apply either:
  - a) The instructions in this manual; or
  - b) Information provided on labels affixed to the product.

VESTIL is not responsible for any consequential damages sustained as a result of failing to exercise sound judgment while assembling, installing, using or maintaining this product.

### **Table of Contents**

Signal words.....	2
Safe use recommendations.....	2
Exploded parts diagrams and bills of materials.....	3 – 6
Product specifications.....	7
Installation instructions.....	7
Assembly instructions.....	7 – 8
Using the tripod.....	9
Inspections & Maintenance.....	9
Label placement diagram.....	9
Limited warranty.....	10

## Signal Words

This manual uses SIGNAL WORDS to indicate the likelihood of personal injuries, as well as the probable seriousness of those injuries, if the product is misused in the ways described. Other signal words call attention to uses of the product likely cause property damage.

The signal words used appear below along with the meaning of each word:



Identifies a hazardous situation which, if not avoided, **WILL** result in **DEATH** or **SERIOUS INJURY**. Use of this signal word is limited to the most extreme situations.



Identifies a hazardous situation which, if not avoided, **COULD** result in **DEATH** or **SERIOUS INJURY**.



Indicates a hazardous situation which, if not avoided, **COULD** result in **MINOR** or **MODERATE** injury.



Identifies practices likely to result in product/property damage, such as operation that might damage the product.

## Safe use recommendations

VESTIL strives to identify foreseeable hazards associated with the use of its products. However, material handling is inherently dangerous and no manual can address every conceivable risk. The end-user ultimately is responsible for exercising sound judgment at all times.



Electrocution might result if any part of the tripod or a load suspended from it contacts electrified wires.



If this product is used improperly or carelessly, the user and/or bystanders might sustain serious personal injuries or even be killed. **Each person who assembles uses or maintains this tripod should read and understand the entire manual before installing, using or servicing the product for the first time. Failure to do so is a misuse of the product. If you do not understand an instruction, ask your supervisor for clarification.** To reduce the likelihood of injury:

- Read the manual to refresh your understanding of proper use and maintenance procedures when necessary.
- DO NOT attempt to resolve any problem with the product unless you are both authorized to do so and certain that it will be safe to use afterwards.
- Inspect the product before each use, as described in “Inspections & Maintenance Recommendations” on p. 9, to confirm normal condition. DO NOT use the product if any unusual noise or movement is observed. If a malfunction occurs, remove the unit from service and notify your supervisor & maintenance personnel about the issue.
- DO NOT exceed the capacity of the tripod (see “Product specifications” table on p. 7 and “Labeling diagram” on p. 9).
- DO NOT stand, or allow other persons to stand, reach, or crawl beneath any elevated part of the tilter.
- DO NOT modify the tripod or any component of the lifter in any way UNLESS you first obtain written approval from Vestil. Unauthorized modifications automatically void the Limited Warranty (p. 10) and might make the device unsafe to use.
- DO NOT use the tripod UNLESS all product labels (see “Labeling diagram” on p. 9) are readable and undamaged.



Proper use, maintenance, and storage are essential for this product to function properly.

- Always use this product in accordance with the instructions in this manual and consistent with any training relevant to hoists and rigging used in conjunction with this product.
- Keep the product clean & dry. Periodically lubricate moving parts.

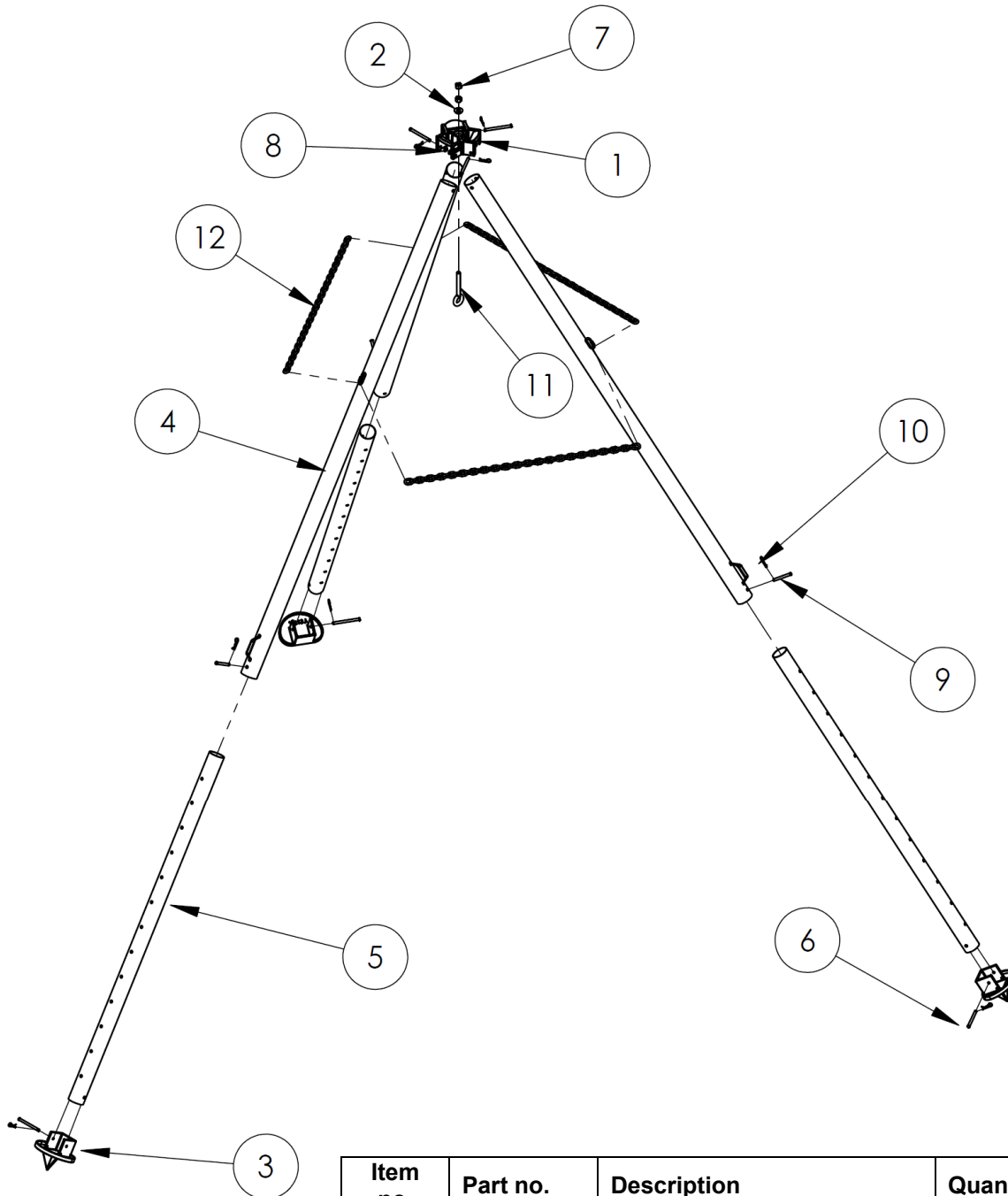
**FIG. 1: TRI-SA Exploded Parts Diagram & Bill of Materials**

Item no.	Part no.	Description	Quantity
1	28-014-155	Top casting	1
2	28-113-010	Beveled washer	1
3	28-014-156	Foot casting	3
4	28-514-083	Outer leg tube	3
5	28-014-114	Inner leg tube	3
6	66125	1/2 in. x 6 in. clevis pin	6
7	36116	3/4 in. - 10 hex nut	2
8	33012	Plain USS flat washer	6
9	66123	1/2 x 4 1/2 clevis pin	3
10	45286	1/8 in. x 2 5/8 in. #11 hitch pin	9
11	28-145-008	3/4 in. x 6 in. eyebolt	1
12	28-145-015	3/8 in. x 52 in. chain	3

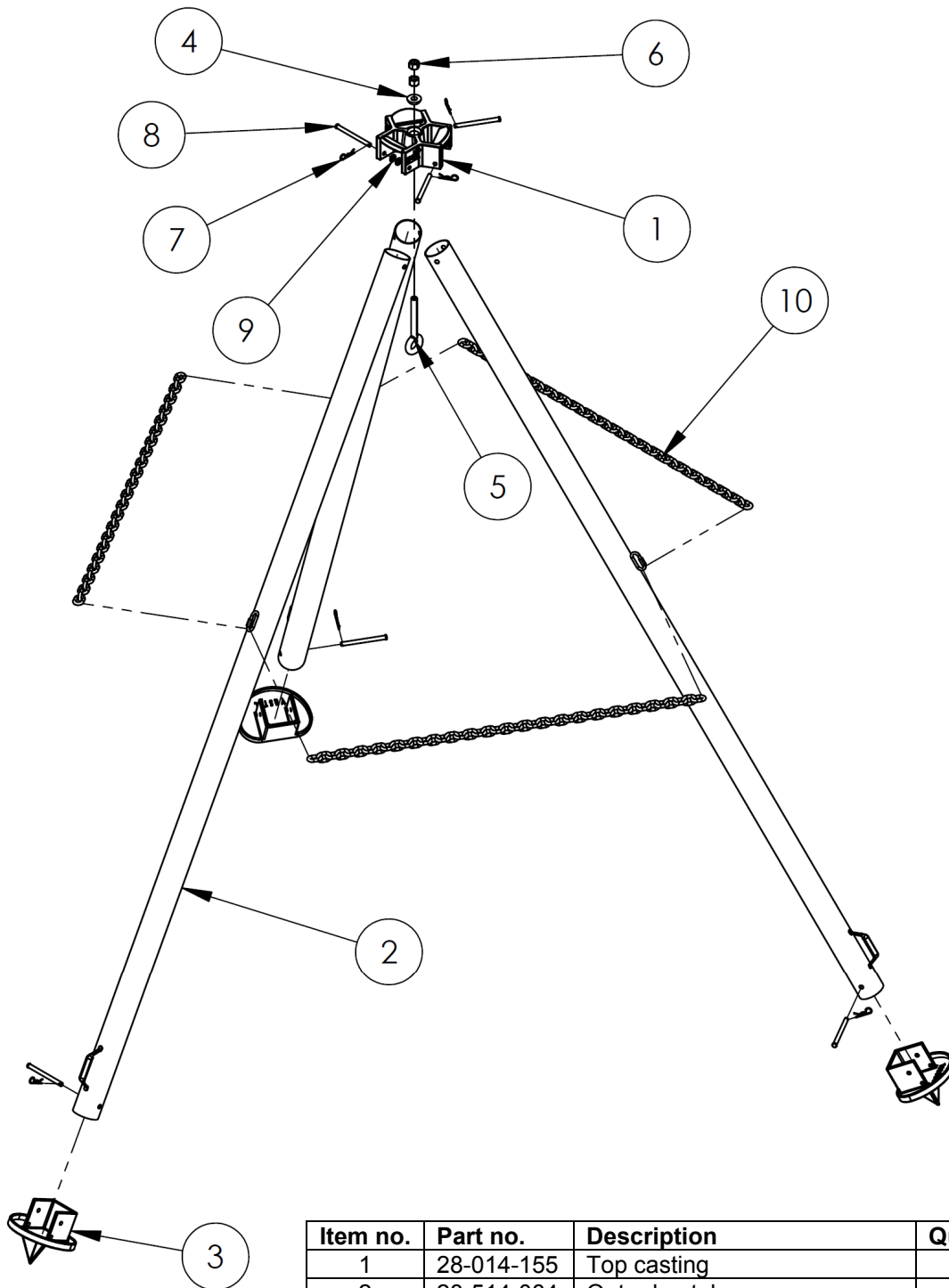
**FIG. 2: TRI-SF Exploded Parts Diagram & Bill of Materials**

Item no.	Part no.	Description	Quantity
1	28-014-155	Top casting	1
2	28-514-084	Outer leg tube	3
3	28-014-156	Foot casting	3
4	28-113-010	Beveled washer	1
5	28-145-008	$\frac{3}{4}$ in. x 6 in. eyebolt	1
6	36116	$\frac{3}{4}$ in. – 10 hex nut	2
7	45286	$\frac{1}{8}$ in. x $2\frac{9}{8}$ in. #11 hitch pin	6
8	66125	$\frac{1}{2}$ in. x 6in. clevis pin	6
9	33012	Plain USS flat washer	6
10	28-145-015	$\frac{3}{8}$ in. x 52 in. chain	3

**FIG. 3: TRI-AA Exploded Parts Diagram & Bills of Materials**

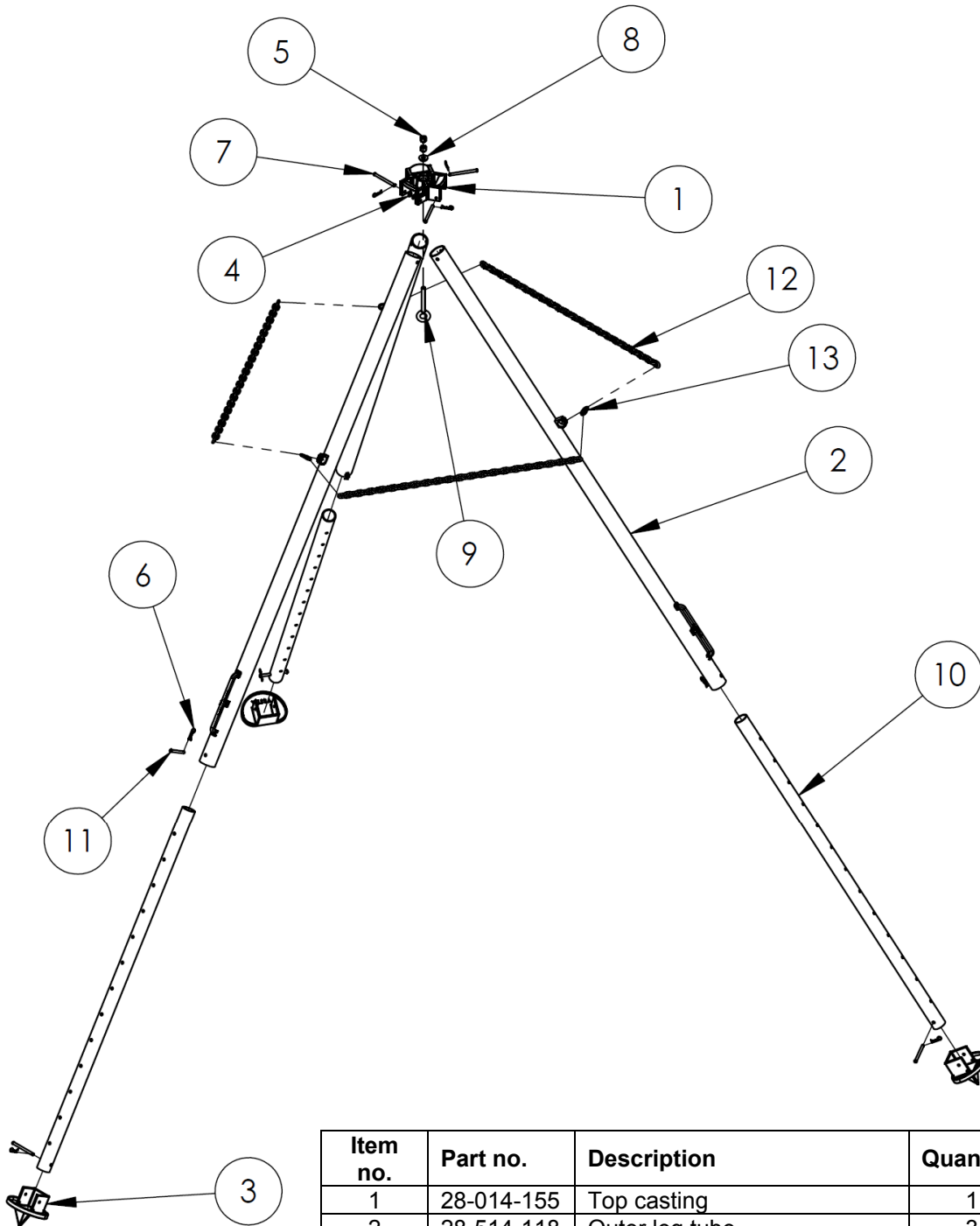

Item no.	Part no.	Description	Quantity
1	28-014-155	Top casting	1
2	28-514-118	Outer leg tube	3
3	28-014-156	Foot casting	3
4	33012	Plain USS flat washer	6
5	36116	$\frac{3}{4}$ in. – 10 hex nut	2
6	45286	$\frac{1}{8}$ in. x $2\frac{5}{8}$ in. #11 hitch pin	9
7	66125	$\frac{1}{2}$ in. x 6 in. clevis pin	6
8	28-113-010	Beveled washer	1
9	28-145-008	$\frac{3}{4}$ in. x 6 in. eyebolt	1
10	28-014-182	Inner leg tube	3
11	66123	$\frac{1}{2}$ in. x $4\frac{1}{2}$ in. clevis pin	3
12	28-145-015	$\frac{3}{8}$ in. x 52 in. chain	3
13	45214	$\frac{5}{16}$ in. quick link	3

**FIG. 4: TRI-AF Exploded Parts Diagram & Bill of Materials**

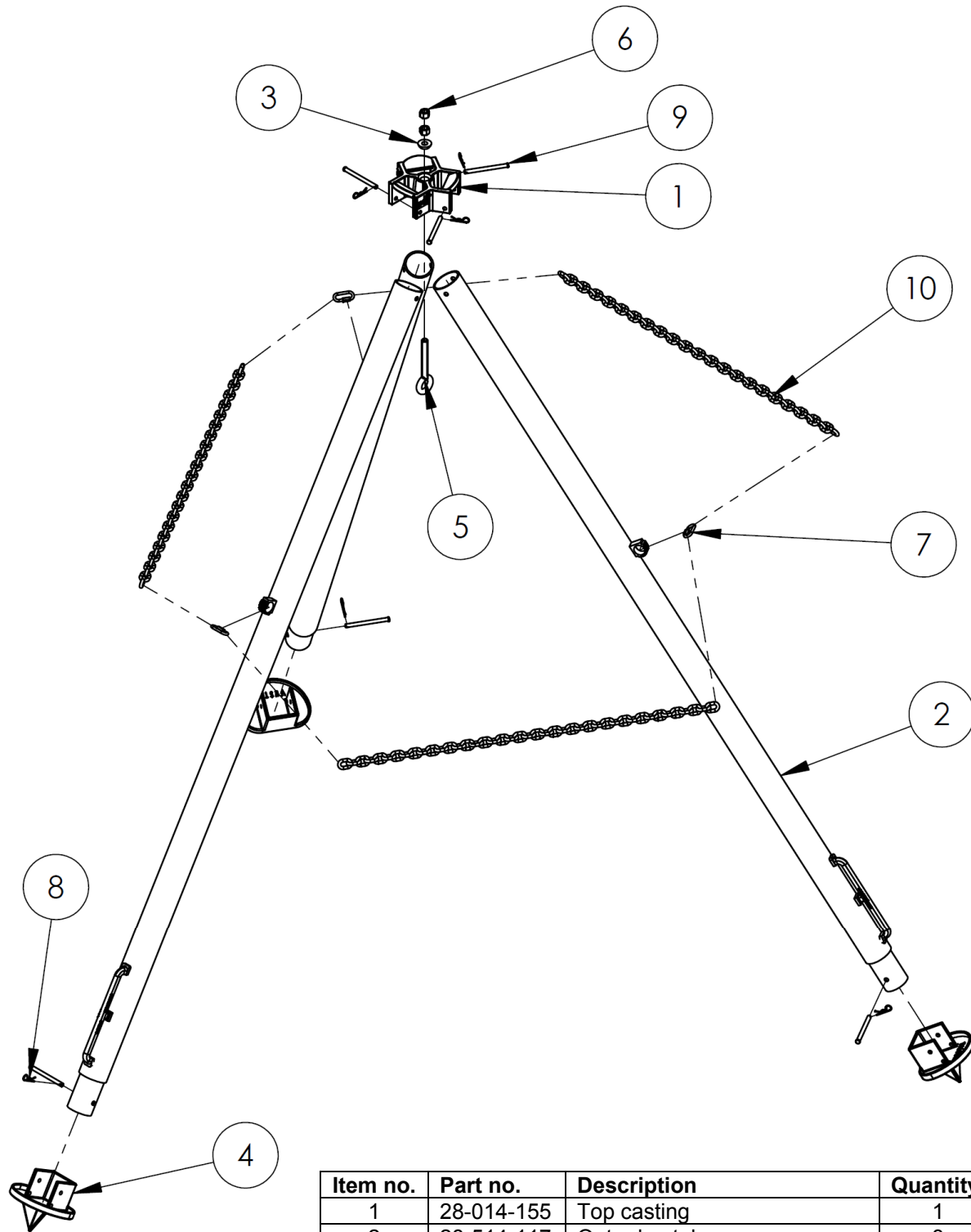

Item no.	Part no.	Description	Quantity
1	28-014-155	Top casting	1
2	28-514-117	Outer leg tube	3
3	28-113-010	Beveled washer	1
4	28-014-156	Foot casting	3
5	28-145-008	$\frac{3}{4}$ in. x 6 in. eyebolt	1
6	36116	$\frac{3}{4}$ in. – 10 hex nut	2
7	45214	$\frac{5}{16}$ in. quick link	3
8	45286	$\frac{1}{8}$ in. x $2\frac{5}{8}$ in. #11 hitch pin	6
9	66125	$\frac{1}{2}$ in. x 6 in. clevis pin	6
10	28-145-015	$\frac{3}{8}$ in. x 52 in. chain	3

## Product specifications

Dimensions and other specifications appear in the table below:

Model	Description	Eyelet height	Capacity	Net weight
TRI-SA	Leg length adjustable	107" to 168 <sup>7</sup> / <sub>8</sub> "	2,000	215.1 lb. 97.8 kg
TRI-SF	Fixed leg length	109 <sup>5</sup> / <sub>8</sub> "	2,000	160.4 lb. 72.9 kg
TRI-AA	Leg length is adjustable	106 <sup>1</sup> / <sub>2</sub> " to 168"	1,000	159.2 lb. 72.4 kg
TRI-AF	Fixed leg length	106 <sup>7</sup> / <sub>8</sub> "	1,000	143.6 lb. 65.3 kg

## Assembly instructions [refer to the exploded part diagram for the appropriate model]

To assemble the tripod, perform the following steps:

1. Pin the upper end each outer leg tube to the top casting with 6in. clevis pins (part no. 66125). [NOTE: A handle is welded to the lower end of each outer leg tube.] Secure the clevis pins with hitch pins.

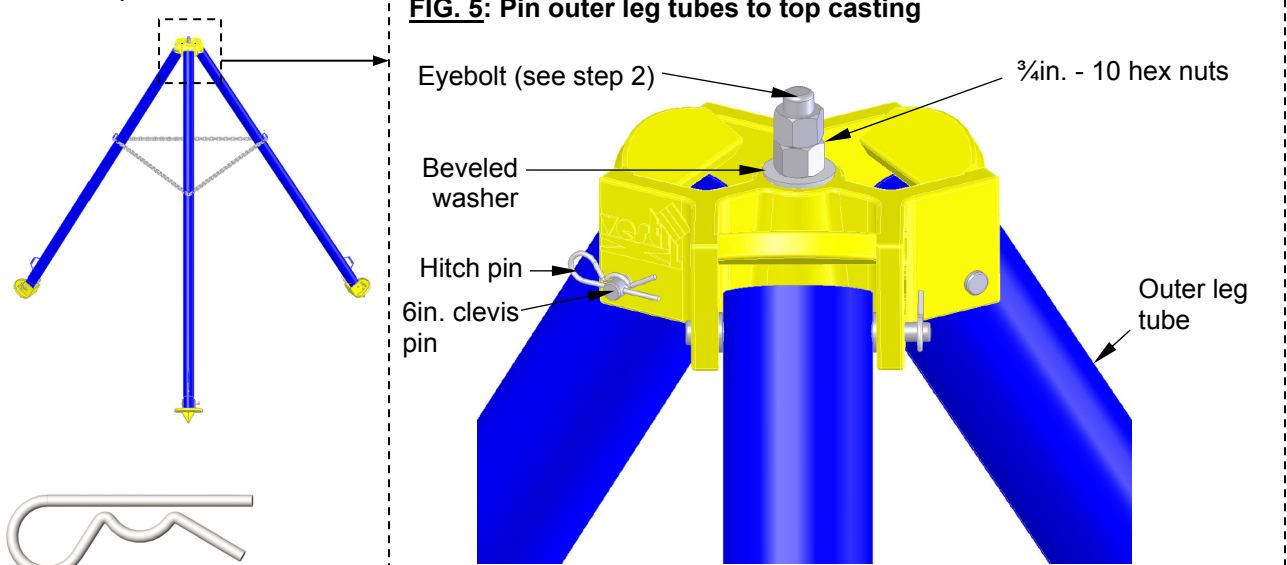

$\frac{1}{8}$  in. x  $2\frac{5}{8}$  in. #11 hitch pin

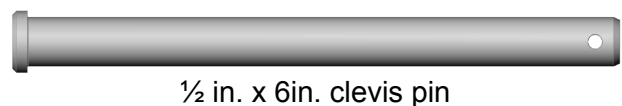
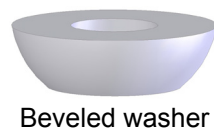
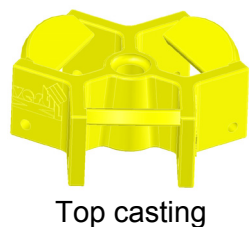
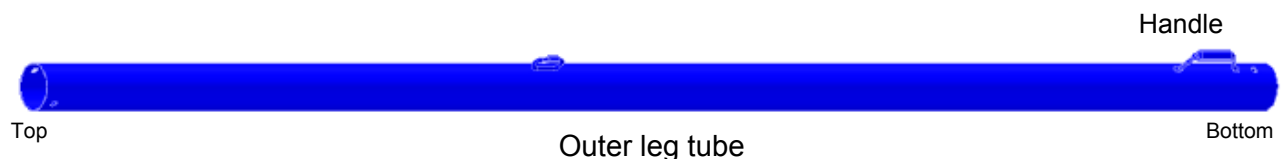

2. Install the eyebolt. Feed the bolt up through the hole in the center of the top casting. As shown in FIG. 5 on p. 7, slide the beveled washer over the end of the bolt with the larger side facing up, and secure the bolt in place with hex nuts.

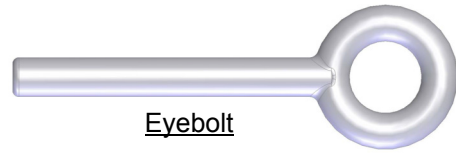

Eyebolt

3. If your tripod has adjustable legs (models TRI-SA & TRI-AA), pin the inner leg tubes to the outer leg tubes next. Notice that the inner leg tubes have a series of pin holes along the length of the tube. The lower end of each inner leg tube has 2 additional holes for pins that connect to the feet.

FIG. 6: Assembly

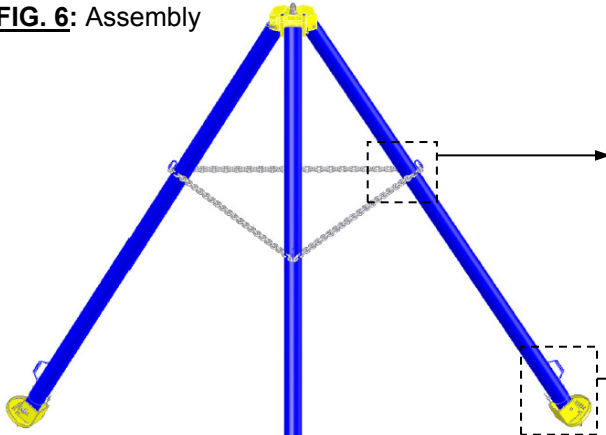

FIG. 6A

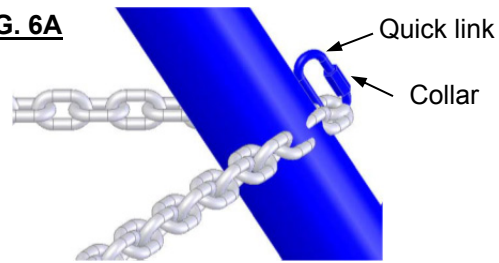

FIG. 6B: Pin inner & outer leg tubes together

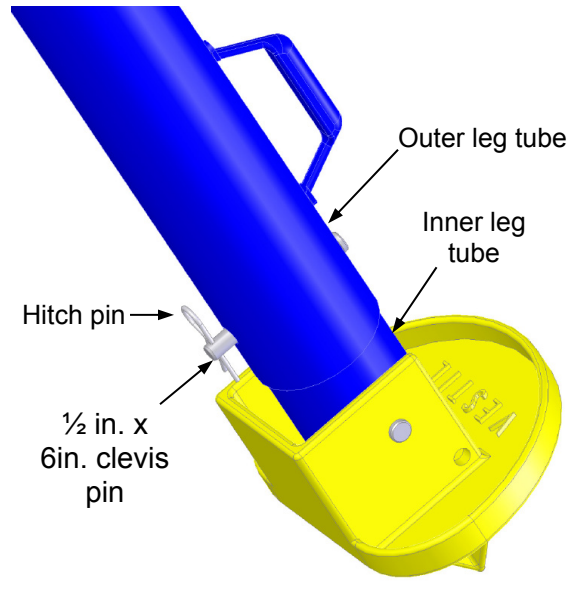
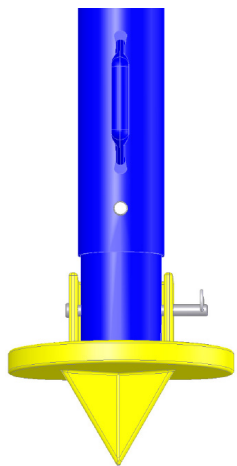

FIG. 6C: Attach foot castings



4. Attach the foot castings to the lower end of the leg tubes with 1/2 in. x 4 1/2 in. clevis pins. Secure the pins with hitch pins.

5. Select the appropriate foot casting orientation for the usage environment. Pivot the foot castings to present either a spiked or smooth face.

FIG. 7A: Use spiked face on loose ground



FIG. 7B: Use the smooth face on packed or improved surfaces

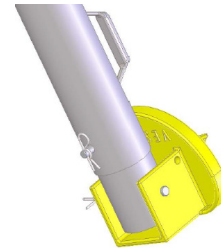

6. Attach the chains to the 5/16 in. quick links welded to the (upper) leg tubes. Attach the end links of each chain to the quick links as shown in FIG. 6A.



## Using the tripod

Attach a chain hoist or other lifting device to the eyelet.

**⚠ WARNING** The capacity of the hoist should equal the capacity of the tripod. Subtract the weight of the hoist from the capacity of the tripod. DO NOT exceed the capacity of the tripod or the hoist, whichever is smaller. The capacity of each tripod model is listed in the table on p. 7 and displayed on label 287 (see “Label placement diagram” below).

Adjust the length of each leg as needed to allow the hoist chain/cable, etc. to hang vertically. The legs of models TRI-SA and TRI-AA can be adjusted in 6 inch increments. To adjust the length of a leg:

1. Align the appropriate pin hole in the inner leg tube with the pin holes in the outer leg tube.
2. Insert a ½ in. x 4½ in. clevis pin through the pin holes in both tubes; and
3. Secure the clevis pin with a 1⁄8 in. x 2<sup>5</sup>/<sub>8</sub> in. #11 hitch pin.

## Inspections & Maintenance

Inspect the tripod at least as frequently as indicated in this section to confirm that it is in normal operating condition.

Before each use, inspect the listed components. Do not use the tripod unless all components are in normal condition:

1. Top casting: the top casting should be square and rigid and should lack cracks, warps, etc.
2. Leg tubes: confirm that the attachments to the top casting and to the foot castings are sound. Also examine the ends of all leg tubes for flares, cracks, bends, and warps.
3. Clevis pins, hitch pins and pin holes: inspect all of the clevis pins (part numbers 66125 & 66123 in the exploded parts diagrams). Check pin holes for elongations, cracks, and deformation. Confirm that pins are straight and without cracks or warps.
4. Eyebolt and fasteners (hardware): tighten loose fasteners and replace any fastener that is damaged;
5. Hinge link assembly (powered units): confirm that the link assembly is not warped or cracked
6. Crossbar support (manual models): examine the crossbar and confirm that it is structurally sound. For example, it should not be warped, cracked, bent, or excessively rusted or corroded.
7. Product labels: all labels should be readable and located as shown below. Replace all labels that are unreadable or missing.
8. Overall condition of the tilter: the structure should be clean, square and rigid, and free of rust and corrosion. Remove dirt and debris.
9. Chains: check all chains and 5⁄16 in. quick links for elongations, cracks, and deformation.
10. Welds: confirm that all welds are intact.

## Labeling diagram

Each tripod should be labeled as shown on this page. Replace any label that is damaged or unreadable. DO NOT use the tripod unless all labels are in place.

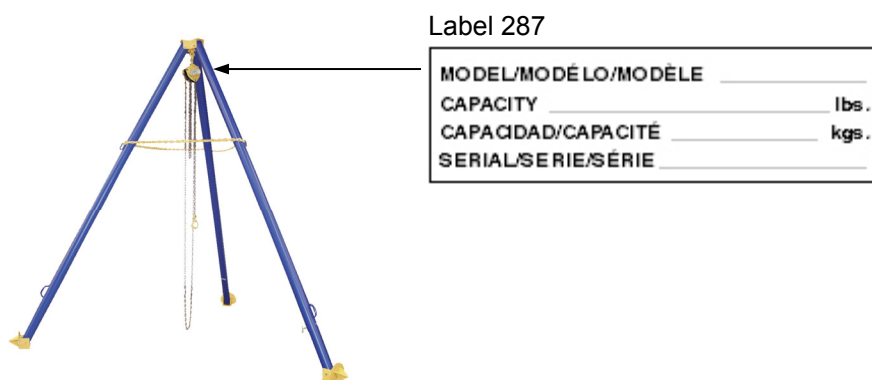

## LIMITED WARRANTY

Vestil Manufacturing Corporation (“Vestil”) warrants this product to be free of defects in material and workmanship during the warranty period. *Our warranty obligation is to provide a replacement for a defective original part if the part is covered by the warranty, after we receive a proper request from the warrantee (you) for warranty service.*

### Who may request service?

Only a warrantee may request service. *You are a warrantee if* you purchased the product from Vestil or from an authorized distributor AND Vestil has been fully paid.

### What is an “original part”?

An original part is a part used to make the product as shipped to the warrantee.

### What is a “proper request”?

A request for warranty service is proper if Vestil receives: 1) a photocopy of the Customer Invoice that displays the shipping date; AND 2) a written request for warranty service including your name and phone number. Send requests by any of the following methods:

Mail  
Vestil Manufacturing Corporation  
2999 North Wayne Street, PO Box 507  
Angola, IN 46703

Fax  
(260) 665-1339  
Phone  
(260) 665-7586

Email  
sales@vestil.com

In the written request, list the parts believed to be defective and include the address where replacements should be delivered.

### What is covered under the warranty?

After Vestil receives your request for warranty service, an authorized representative will contact you to determine whether your claim is covered by the warranty. Before providing warranty service, Vestil may require you to send the entire product, or just the defective part or parts, to its facility in Angola, IN. The warranty covers defects in the following *original* dynamic components: motors, hydraulic pumps, electronic controllers, switches and cylinders. It also covers defects in *original* parts that wear under normal usage conditions (“wearing parts”), such as bearings, hoses, wheels, seals, brushes, and batteries.

### How long is the warranty period?

The warranty period for original dynamic components is 30 days. For wearing parts, the warranty period is 30 days. The warranty periods begin on the date when Vestil ships the product to the warrantee. If the product was purchased from an authorized distributor, the periods begin when the distributor ships the product. Vestil may, at its sole discretion, extend the warranty periods for products shipped from authorized distributors by *up to* 30 days to account for shipping time.

### If a defective part is covered by the warranty, what will Vestil do to correct the problem?

Vestil will provide an appropriate replacement for any *covered* part. An authorized representative of Vestil will contact you to discuss your claim.

### What is not covered by the warranty?

1. Labor;
2. Freight;
3. Occurrence of any of the following, which automatically voids the warranty:

- Product misuse;
- Negligent operation or repair;
- Corrosion or use in corrosive environments;
- Inadequate or improper maintenance;
- Damage sustained during shipping;
- Collisions or other incidental contacts causing damage to the product;
- Unauthorized modifications: DO NOT modify the product IN ANY WAY without first receiving written

authorization from Vestil. Modification(s) might make the product unsafe to use or might cause excessive and/or abnormal wear.

### Do any other warranties apply to the product?

Vestil Manufacturing Corp. makes no other express warranties. All implied warranties are disclaimed to the extent allowed by law. Any implied warranty not disclaimed is limited in scope to the terms of this Limited Warranty.

